

SUBMITTAL TO THE BOARD OF SUPERVISORS
COUNTY OF RIVERSIDE, STATE OF CALIFORNIA

2178



FROM: TLMA – Transportation Dept. SUBMITTAL DATE: June 2, 2003

SUBJECT: Approval of **TRACT 28684**
A Schedule "A" Subdivision in the Eastvale Area

RECOMMENDED MOTION: That the Board approve the Improvement Agreements and Securities as approved by County Counsel, approve the final map and authorize the Chairman to sign the Improvement Agreements and map for Tract 28684.

BACKGROUND: This map complies in all respects with the provisions of Division 3 of Title 15 of the Government Code and applicable local ordinances. The developer desires to enter into Improvement Agreements to guarantee the construction of the required improvements and has submitted Improvement Agreements and Securities which have been approved by County Counsel.

REVIEWED BY EXECUTIVE OFFICE
George A. Johnson
DATE: *June 2, 2003*

George A. Johnson
George A. Johnson
Director of Transportation

HS:lf
Submittals: Final Map
Road/Drainage Improvement Agrmts
Water System Improvement Agrmts
Sewer System Improvement Agrmts
Survey Monument Agreements

Department Recommendation: Consent Policy
Per Executive Office: Consent Policy

Prev. Agn. Ref.

Dist. 2

AGENDA NO.

2.21

VICINITY MAP
NOT TO SCALE

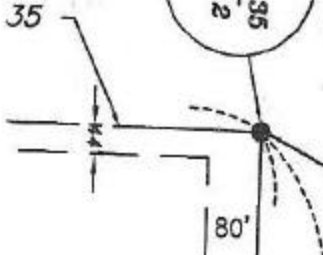
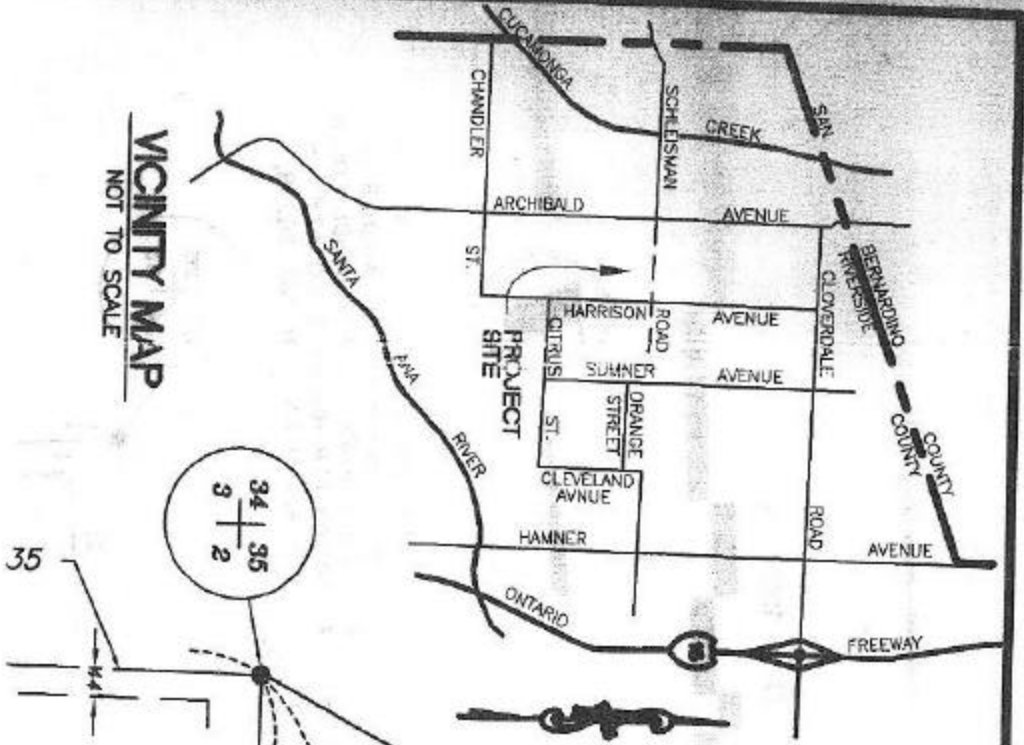

SOUTHWEST CORNER SECTION 35, T. 25 S., R. 7 W.
 FOUND RIVERSIDE COUNTY SURVEY MONUMENT, DOWN 1.3'
 STAMPED AS SHOWN PER THE BOOK 43/79, AND PG 89/91-95,
 AND P.M. NO. 28278, P.M.B. 192/1-16.

WEST LINE SECTION 35

BEING A SUBDIVISION OF
 PAGES 1 THROUGH 16, IN

(2644)00